

# UniTrack / UniBeam Cord Guide - Side Cording



## Technical Details

**Part No:** TRA1906

**Weight:** 0.754 kg

**WLL:** N/A

**Material:** Mild Steel & Nylon PA6

**Finish:** Black Powder Coated

The TRA1906 Side Cord guide for UniTrack and UniBeam it provides support for the operating cord on side cored systems to prevent cord sag over long distances. See cording diagrams for mounting and use details.

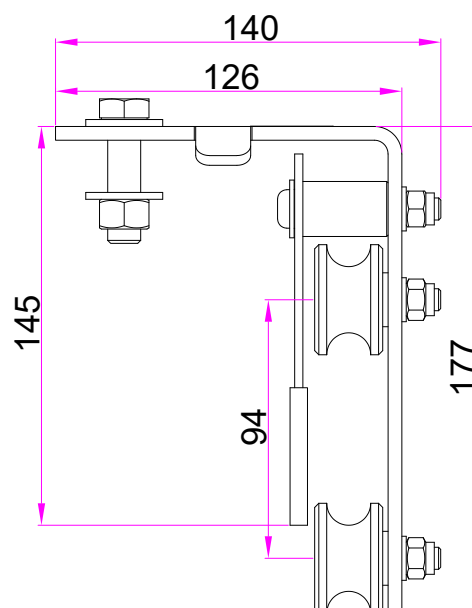
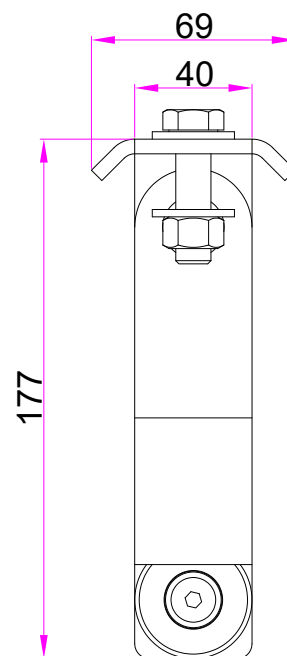

+44 (0) 1959 570 333  
www.triplee.ltd  
info@triplee.ltd  
@tripleeltd

Equipment Engineered for Entertainment

